

MIG/MAG Welding Torches MB EVO PRO 25

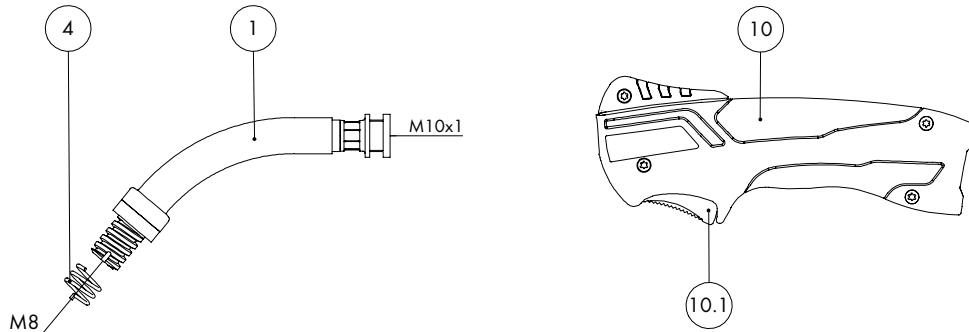

| Pos. | Description | Details | Part-No. | Product group |
|-----------------------------|---|----------|------------|---------------|
| Torch | | | | |
| | MB EVO PRO 25; central adaptor KZ-2; 3.00 m | | 004.0671.1 | 1073 |
| | MB EVO PRO 25; central adaptor KZ-2; 4.00 m | | 004.0672.1 | 1073 |
| | MB EVO PRO 25; central adaptor KZ-2; 5.00 m | | 004.0673.1 | 1073 |
| Swan neck | | | | |
| 1 | Swan neck MB EVO PRO 25; 50° bent | | 004.0663.1 | 1007 |
| 4 | Nozzle spring | 100 Pcs. | 003.0013 | 1095 |
| Handle MB EVO PRO 2K | | | | |
| 10 | Handle MB EVO PRO 2K; 2-pole ac complete | | 180.0176.1 | 1095 |
| 10.1 | Trigger ergonomic 2-pol.; MB EVO PRO / MB EVO | | 185.0142.1 | 9010 |
| Cable assembly | | | | |
| 40 | Bikox® LW-power cable, R28 for 3.00 m | | 160.H032.1 | 1511 |
| 40 | Bikox® LW-power cable, R28 for 4.00 m | | 160.H033.1 | 1511 |
| 40 | Bikox® LW-power cable, R28 for 5.00 m | | 160.H034.1 | 1511 |
| 40.1 | Hexagon nut M10x1 | 10 Pcs. | 001.0009 | 9010 |
| 44 | Trigger wire connector | 20 Pcs. | 175.0022 | 9010 |
| 45 | Insulating sleeve | 20 Pcs. | 400.0119 | 1095 |
| 46 | Male connector | 20 Pcs. | 175.0004 | 9010 |
| 47 | Half ring D=37; raspberry red; MB EVO PRO | 2 Pcs. | 400.D561.2 | 1595 |
| 48 | Cable support short ND 17-22 | | 400.D574.1 | 1595 |
| 54 | Cable support ND 19 | | 400.1010 | 1095 |
| 56 | Connection housing ac complete; MB EVO PRO / MB EVO | | 501.2673.1 | 9010 |
| 57 | Pan head screw M4x6 | 20 Pcs. | 000.0552 | 9010 |
| 57.1 | Screw cap 1 | 20 Pcs. | 500.0251 | 9010 |
| 58 | Adaptor nut M33x2 | | 500.0213 | 9010 |
| 59 | Central adaptor KZ-2 | | 501.0003 | 1095 |

MIG/MAG Welding Torches MB EVO PRO 25

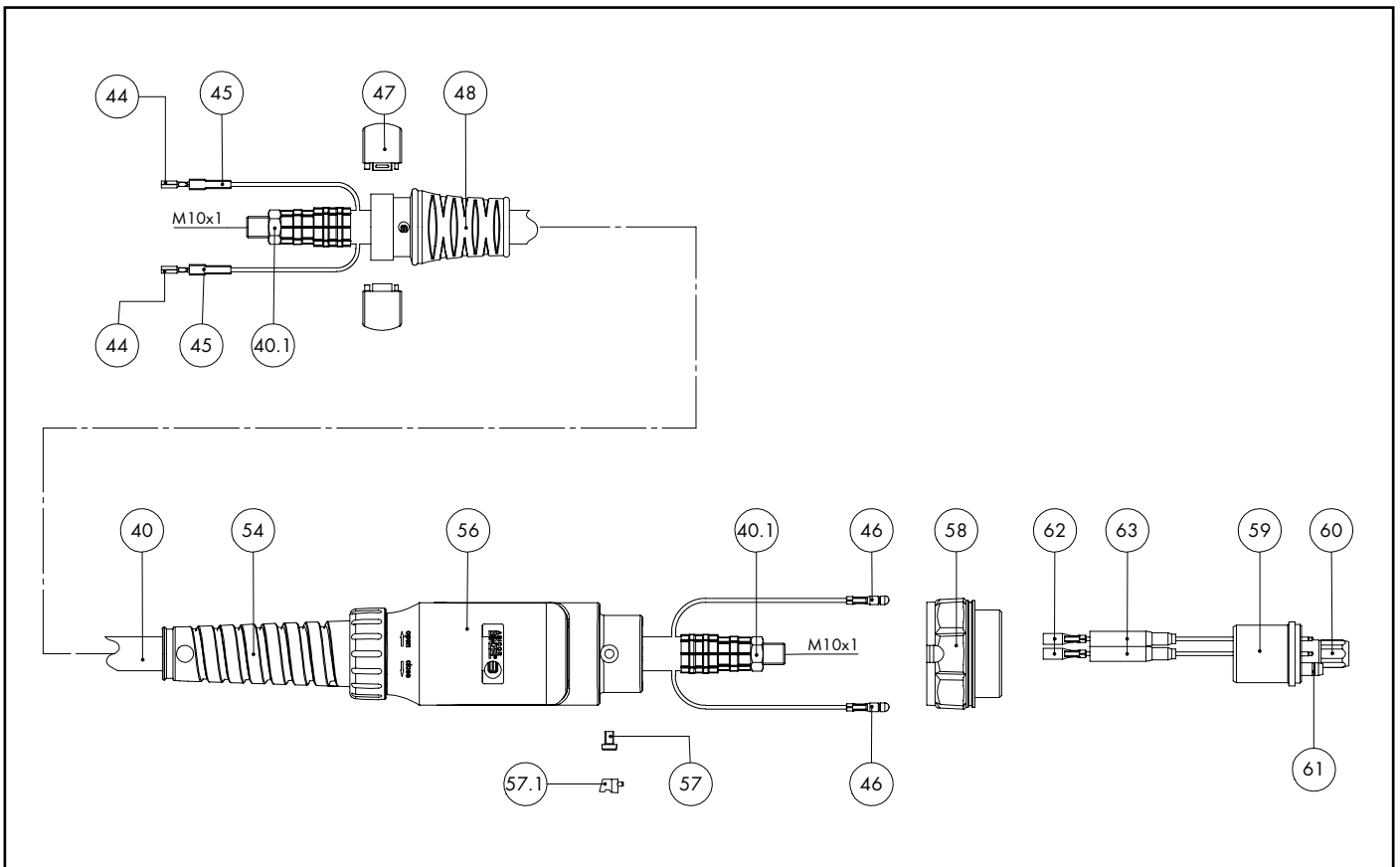

| Pos. | Description | Details | Part-No. | Product group |
|-------------------|---|---------|-------------|---------------|
| 60 | Coupling nut M10x1 | 10 Pcs. | 501.D536 | 1595 |
| 61 | O-Ring 4x1 | 20 Pcs. | 165.0002 | 9010 |
| 62 | Trigger wire connector; female | 20 Pcs. | 175.0003 | 9010 |
| 63 | Insulating sleeve for central adapter | 20 Pcs. | 501.2609.20 | 1395 |
| Wear parts | | | | |
| 80 | Contact tip holder M6; 35.0 mm | 10 Pcs. | 142.0001 | 1033 |
| 81 | Contact tip holder M6; 37.0 mm | 10 Pcs. | 142.0267.10 | 1033 |
| 90 | Contact tip M6 E-Cu; Ø 0.8 (8x28) | 10 Pcs. | 140.0051 | 1030 |
| 90 | Contact tip M6 E-Cu; Ø 1.0 (8x28) | 10 Pcs. | 140.0242 | 1030 |
| 90 | Contact tip M6 E-Cu; Ø 1.2 (8x28) | 10 Pcs. | 140.0379 | 1030 |
| 90 | Contact tip M6 CuCrZr; Ø 0.8 (8x28) | 10 Pcs. | 140.0054 | 1031 |
| 90 | Contact tip M6 CuCrZr; Ø 1.0 (8x28) | 10 Pcs. | 140.0245 | 1031 |
| 90 | Contact tip M6 CuCrZr; Ø 1.2 (8x28) | 10 Pcs. | 140.0382 | 1031 |
| 90 | Contact tip M6 E-Cu; Ø 0.8 for alu wire (8x28) | 10 Pcs. | 141.0001 | 1030 |
| 90 | Contact tip M6 E-Cu; Ø 1.0 for alu wire (8x28) | 10 Pcs. | 141.0006 | 1030 |
| 90 | Contact tip M6 E-Cu; Ø 1.2 for alu wire (8x28) | 10 Pcs. | 141.0010 | 1030 |
| 90 | Contact tip M6 CuCrZr silver-plated; Ø 0.8 (8x28) | 10 Pcs. | 147.0054 | 1031 |
| 90 | Contact tip M6 CuCrZr silver-plated; Ø 1.0 (8x28) | 10 Pcs. | 147.0245 | 1031 |
| 90 | Contact tip M6 CuCrZr silver-plated; Ø 1.2 (8x28) | 10 Pcs. | 147.0382 | 1031 |
| 100 | Gas nozzle; cylindrical; ND Ø 18.0 | 10 Pcs. | 145.0042 | 1036 |
| 102 | Gas nozzle; conical; ND Ø 15.0 | 10 Pcs. | 145.0076 | 1036 |
| 103 | Gas nozzle; conical; with extended insulation; ND Ø 15.0 | 10 Pcs. | 145.0100 | 1036 |
| 104 | Gas nozzle; tapered; ND Ø 11.5 | 10 Pcs. | 145.0124 | 1036 |
| 109 | Spot weld gas nozzle; ND Ø 18.0 | 10 Pcs. | 145.0169 | 1036 |
| 120 | Guide spiral liner insulated; 1.5/4.0; blue; for wire Ø 0.6-0.8; for 3.00 m | | 124.0011 | 1034 |
| 120 | Guide spiral liner insulated; 1.5/4.0; blue; for wire Ø 0.6-0.8; for 4.00 m | | 124.0012 | 1034 |

MIG/MAG Welding Torches MB EVO PRO 25

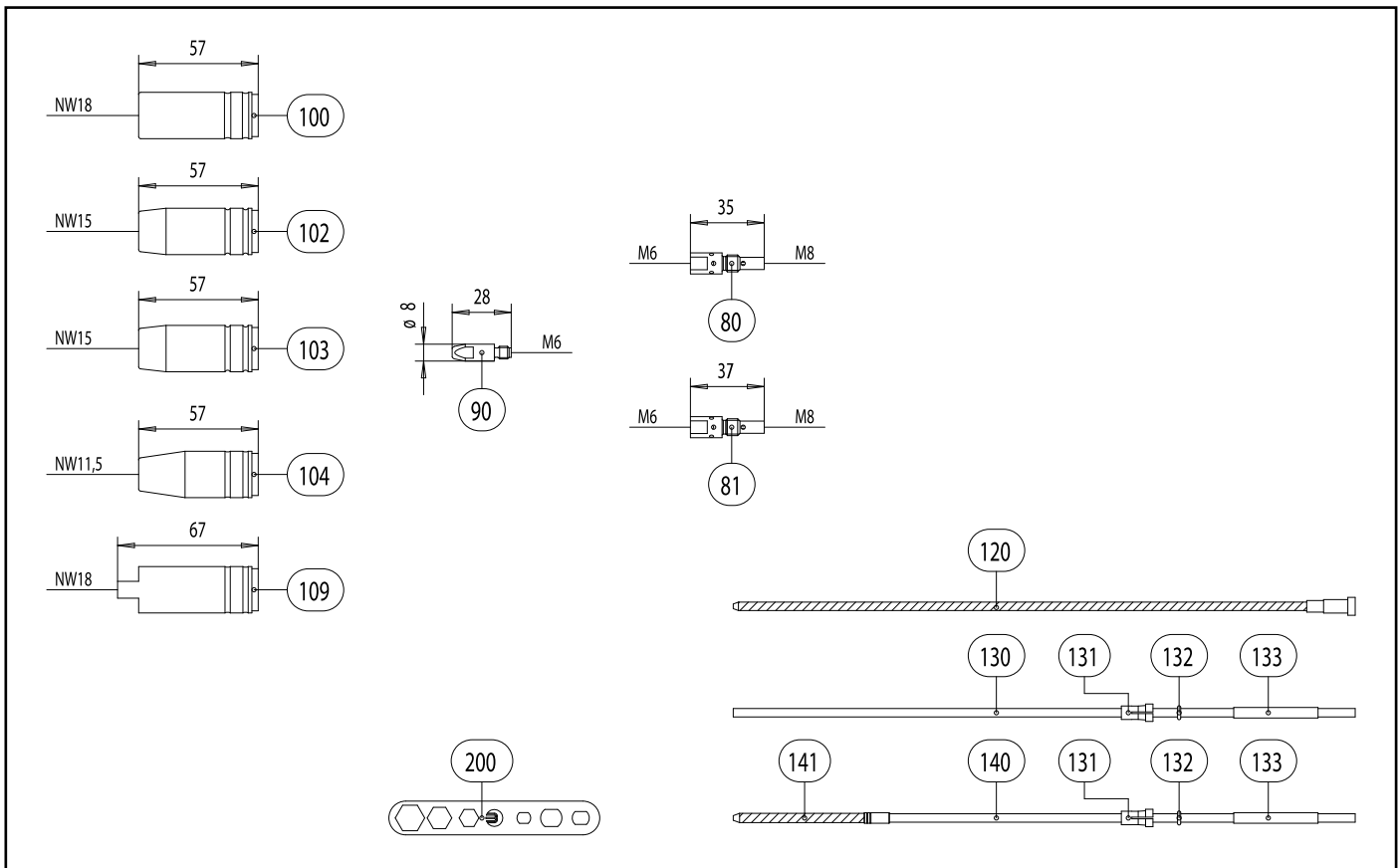

Pos. Description

| Pos. | Description | Details | Part-No. | Product group |
|------|---|---------|----------|---------------|
| 120 | Guide spiral liner insulated; 1.5/4.0; blue; for wire Ø 0.6-0.8; for 5.00 m | | 124.0015 | 1034 |
| 120 | Guide spiral liner insulated; 2.0/4.5; red; for wire Ø 1.0-1.2; for 3.00 m | | 124.0026 | 1034 |
| 120 | Guide spiral liner insulated; 2.0/4.5; red; for wire Ø 1.0-1.2; for 4.00 m | | 124.0031 | 1034 |
| 120 | Guide spiral liner insulated; 2.0/4.5; red; for wire Ø 1.0-1.2; for 5.00 m | | 124.0035 | 1034 |
| 130 | PTFE core liner 1.5/4.0; blue; wire electrode Ø 0.8-1.0; for 3.00 m | | 126.0005 | 1034 |
| 130 | PTFE core liner 1.5/4.0; blue; wire electrode Ø 0.8-1.0; for 4.00 m | | 126.0008 | 1034 |
| 130 | PTFE core liner 1.5/4.0; blue; wire electrode Ø 0.8-1.0; for 5.00 m | | 126.0011 | 1034 |
| 130 | PTFE core liner 2.0/4.0; red; wire electrode Ø 1.0-1.2; for 3.00 m | | 126.0021 | 1034 |
| 130 | PTFE core liner 2.0/4.0; red; wire electrode Ø 1.0-1.2; for 4.00 m | | 126.0026 | 1034 |
| 130 | PTFE core liner 2.0/4.0; red; wire electrode Ø 1.0-1.2; for 5.00 m | | 126.0028 | 1034 |
| 130 | PTFE carbon core liner 1.5/4.0; wire electrode Ø 0.8-1.0; for 3.00 m | | 127.0002 | 1034 |
| 130 | PTFE carbon core liner 1.5/4.0; wire electrode Ø 0.8-1.0; for 4.00 m | | 127.0003 | 1034 |
| 130 | PTFE carbon core liner 1.5/4.0; wire electrode Ø 0.8-1.0; for 5.00 m | | 127.0004 | 1034 |
| 130 | PTFE carbon core liner 2.0/4.0; wire electrode Ø 1.0-1.2; for 3.00 m | | 127.0005 | 1034 |
| 130 | PTFE carbon core liner 2.0/4.0; wire electrode Ø 1.0-1.2; for 4.00 m | | 127.0007 | 1034 |
| 130 | PTFE carbon core liner 2.0/4.0; wire electrode Ø 1.0-1.2; for 5.00 m | | 127.0008 | 1034 |
| 131 | Nipple for core liner at Ø 4.0 | 20 Pcs. | 131.0001 | 1095 |
| 132 | O-Ring 3.5x1.5 | 20 Pcs. | 165.0008 | 9010 |
| 133 | Guide tube for core liners up to Ø 4.0 (200 mm) | 10 Pcs. | 129.0461 | 1095 |
| 140 | Combined wire guide cpl. polyamide/brass; wire Ø 1.0-1.2; for 3.00 m | | 128.M002 | 1034 |
| 140 | Combined wire guide cpl. polyamide/brass; wire Ø 1.0-1.2; for 4.00 m | | 128.M003 | 1034 |
| 140 | Combined wire guide cpl. polyamide/brass; wire Ø 1.0-1.2; for 5.00 m | | 128.M004 | 1034 |
| 141 | Brass spiral made up with sleeve (200 mm) | 10 Pcs. | 001.0305 | 1095 |
| 200 | Spanner Standard | 10 Pcs. | 191.0001 | 9010 |